

F:\HUFFMORRIS Project Files\St. Michael Lutheran Church\St. Michael AutoCAD\MP1.2 Master Plan.dwg, 5/8/2007 1:24:31 PM

HUFFMORRIS ARCHITECTS P.C. is the author and owner of these instruments of service.

PARKING REQUIREMENTS

| | |
|--------------------------------------|-----|
| PARKING REQUIRED BY CODE: | 110 |
| SUGGEST PARKING @ 2 SPACES PER SEAT: | 178 |
| PARKING SHOWN: | 194 |

MASTER PLAN LEGEND

-  PORTE COCHERE
-  EDUCATIONAL - CHILDREN
-  EDUCATIONAL - YOUTH
-  EDUCATIONAL - ADULT
-  FELLOWSHIP
-  WORSHIP
-  ADMINISTRATION
-  RESTROOM
-  STORAGE / UTILITY
-  CIRCULATION
-  GRASS
-  NEW PARKING
-  EXISTING PARKING
-  NEW SIDEWALK
-  EXISTING SIDEWALK
-  EXISTING BUILDING
-  PROPERTY LINE
-  EASEMENT, R.O.W., OR SETBACK

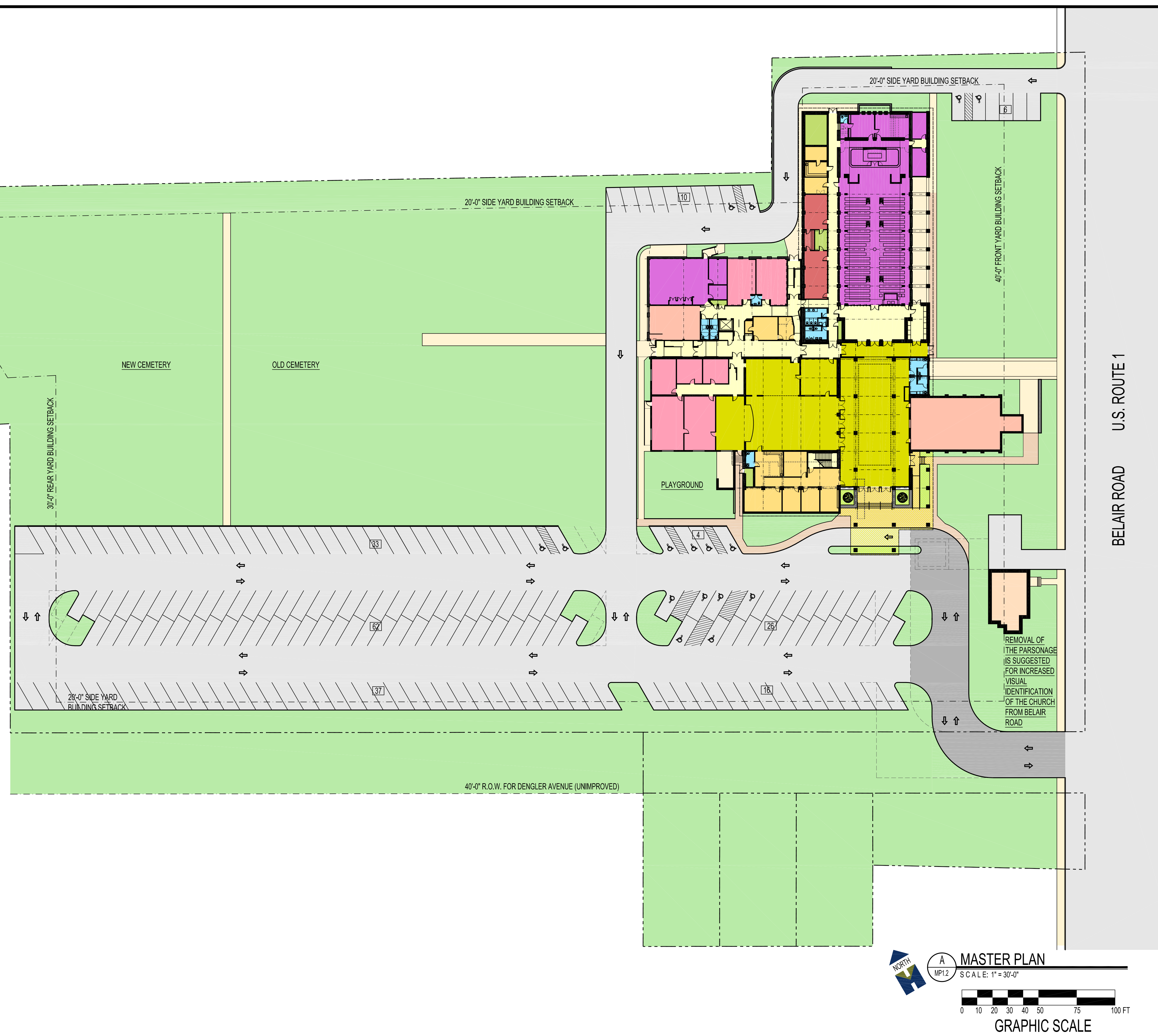

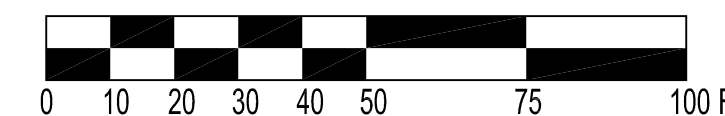
A **MASTER PLAN**
 MP1.2 SCALE: 1" = 30'-0"

GRAPHIC SCALE

**ST. MICHAEL EVANGELICAL
LUTHERAN CHURCH**
9534 BELAIR ROAD BALTIMORE, MD 21236

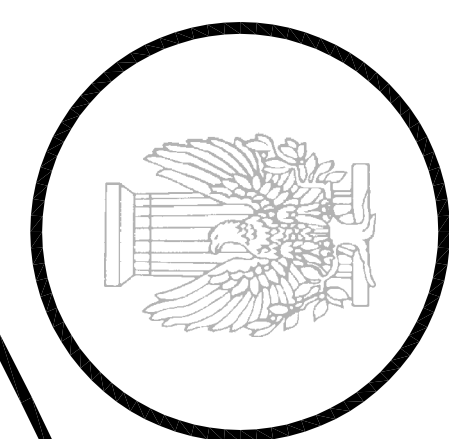
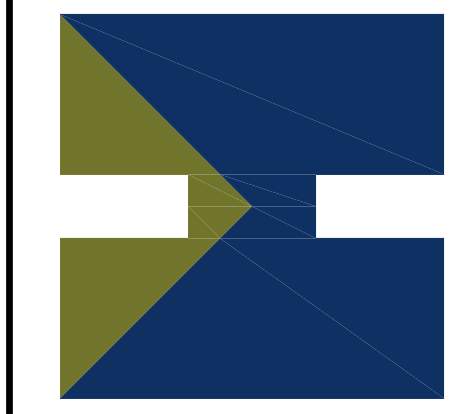
HUFFMORRIS ARCHITECTS
400 EAST GRACE STREET RICHMOND, VIRGINIA 23219
WWW.HUFFMORRIS.COM



2 May 2007

MP1.2

Celebrating Our 77th Anniversary